

# CERTIFICATE OF LOCATION OF GOVERNMENT CORNER

NORTH QUARTER Corner of Section 21, Township 107, Range 43, 5TH P.M.

STATE OF MINNESOTA, County of MURRAY

At the corner location shown on the sketch:

On 03-06-2012 found a PK nail.  
DATE

left monument as found,  lowered monument,  removed monument (explain)

On \_\_\_\_\_ placed a \_\_\_\_\_  
DATE

### SKETCH OF REFERENCE TIES

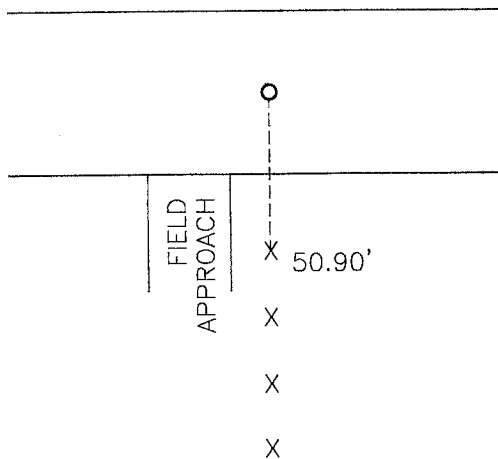

Minnesota State Plane Coordinate  
System Murray County Datum  
NAD83 (1996)

Nail and seal in corner fence post South 50.90'

N: 179603.333  
E: 434979.319

Statement of evidence relative to this corner location is on back of page.

I hereby certify that this document and the data contained herein was prepared by me or under my direct supervision.

*Samuel B. [Signature]* 2/21/13  
SIGNATURE DATE

Registration No. 43844

- Land Surveyor,  Professional Engineer  
 County Surveyor,  County Engineer

OFFICE OF THE COUNTY RECORDER

County of \_\_\_\_\_

I hereby certify that this document was filed in the Co. Recorders office at \_\_\_\_\_ .M on the \_\_\_\_\_ day of MAY 23 2013 A.D. 20 \_\_\_\_\_

County Recorder *James V. Johnson*  
By \_\_\_\_\_, Deputy

DOCUMENT NO. \_\_\_\_\_

## Statement of Evidence

In 1866, J. W. Bishop did the original subdivision of the township.

On July 22, 1983, the Murray County Highway Department found a concrete monument at the corner.

On August 21, 1985, the Murray County Highway Department set a 30" iron at the corner.

On August 20, 1987, the Murray County Highway Department set a PK nail at the surface.

On March 6, 2012, Bueltel-Moseng Land Survey found a PK nail at the surface.